

F-3412012
F-341215L
F-3412201

- I Prima di iniziare il montaggio, identificare tutti i componenti con l'aiuto delle istruzioni.
- GB Before starting to assembly, please identify all components.
- D Vor der Montage, sind die Einzelteile anhand der Montageanleitung zu identifizieren.
- F Avant de débuter le montage, identifiez tous les composants à l'aide de la notice.
- E Antes de iniciar el montaje, identifique todos los componentes con ayuda de la nota.

F-3412012A
F-341215LA
F-3412201A

- I Pezzo di ricambio.
- GB Spare part.
- D Ersatzteil.
- F Pièce en échange / s.a.v.
- E Repuesto

Attenzione-Attention-Vorsicht-Attention-Atención

- I Si consiglia di effettuare il montaggio su una superficie morbida.
- GB It is a good idea to use a soft protective underlay during assembly.
- D Möbelteile auf eine weiche Oberfläche legen und dann aufstellen.
- F Veuillez poser les pièces sur un surface souple pour l'assemblage.
- E Se aconseja efectuar el montaje sobre una superficie blanda.



- I Pezzo di ricambio.
- GB Spare part.
- D Ersatzteil.
- F Pièce en échange / s.a.v.
- E Repuesto

H-A 3412.01 00-0



Calligaris S.p.A.
Via Trieste, 12
33044 Manzano
(Udine) Italy
Tel. +39 0432 748211
calligaris.com

calligaris

Copyright © Calligaris S.p.a. Tutti i diritti riservati - All right reserved

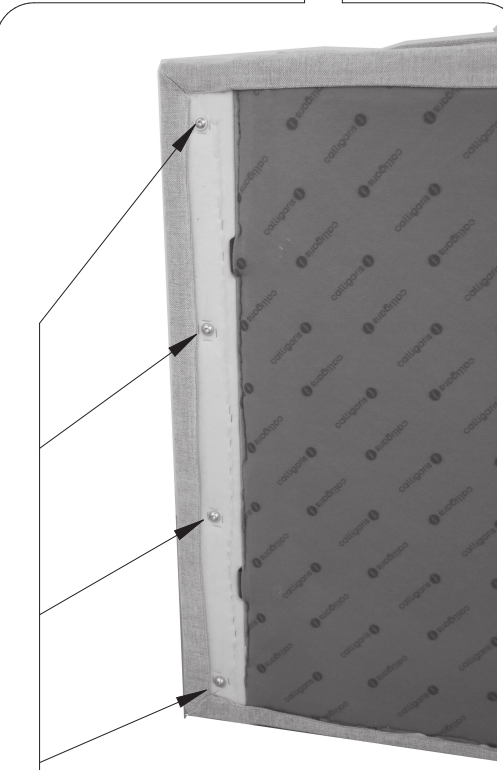
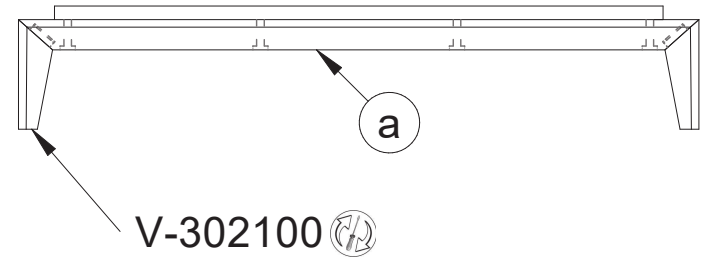
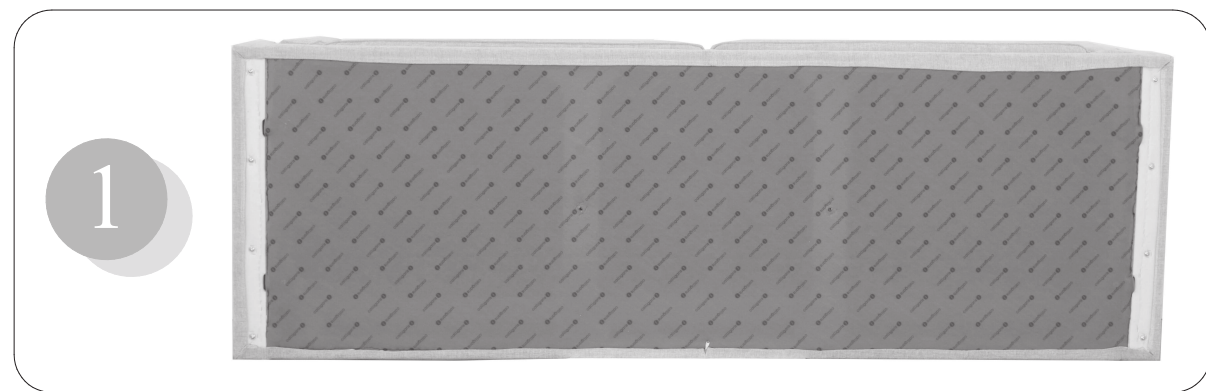

- I Svitare le viti.
- GB Unscrew the screws.
- D Lösen Sie die Schrauben.
- F Dévissez les vis.
- E Destornille los tornillos.

V-0101220207

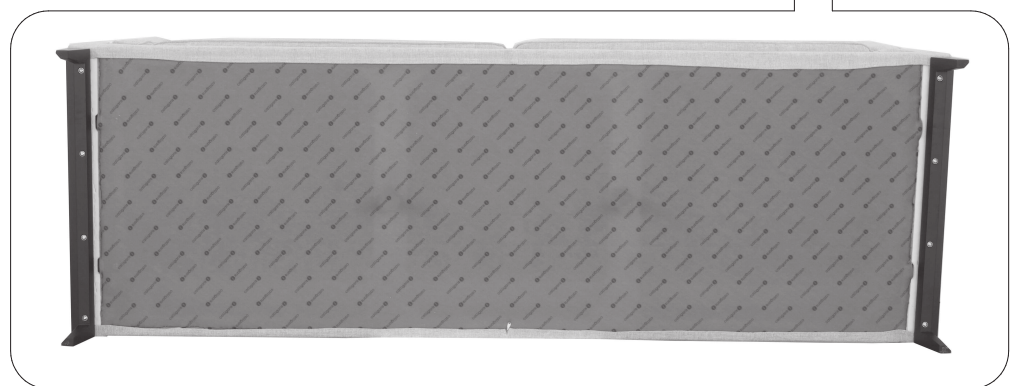
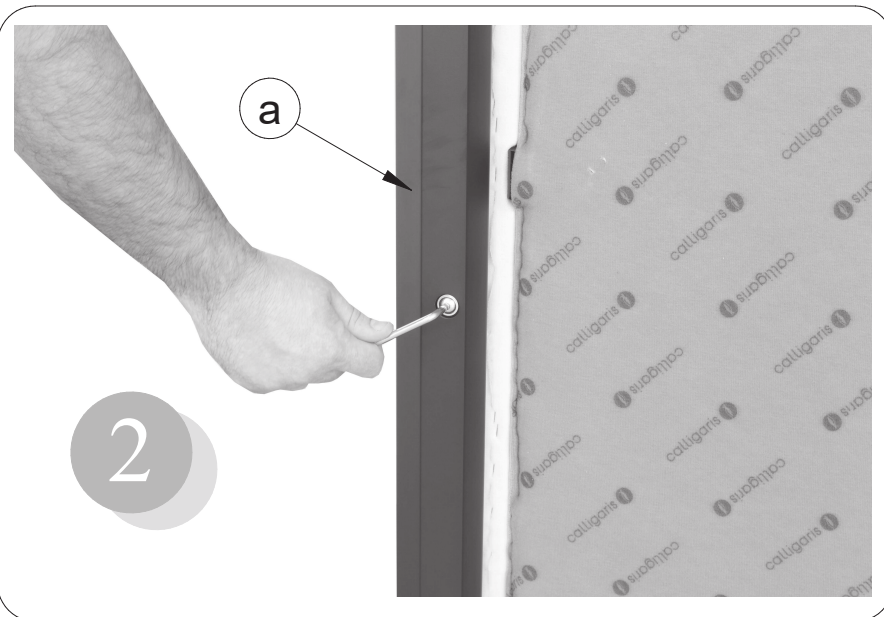

Copyright © Calligaris S.p.a. Tutti i diritti riservati - All right reserved

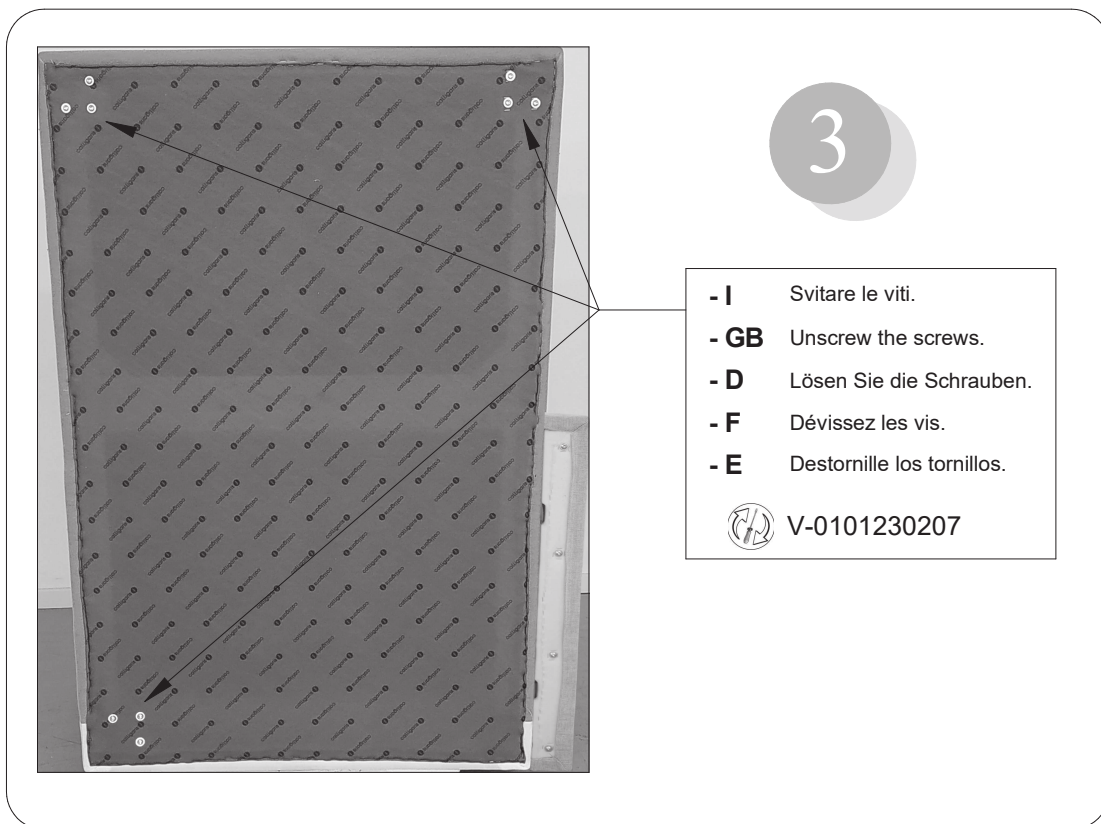

- I Svitare le viti.
- GB Unscrew the screws.
- D Lösen Sie die Schrauben.
- F Dévissez les vis.
- E Destornille los tornillos.

V-0101230207

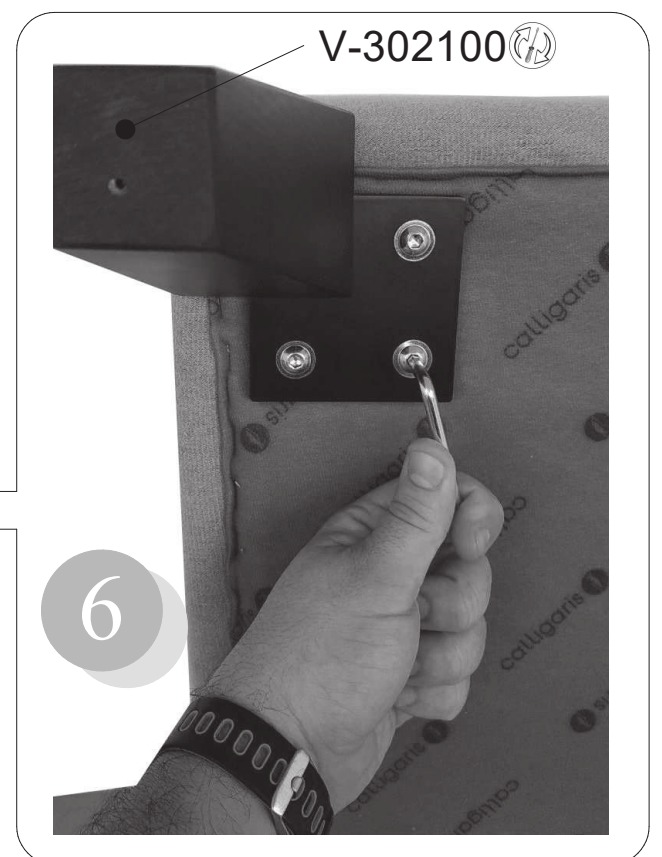
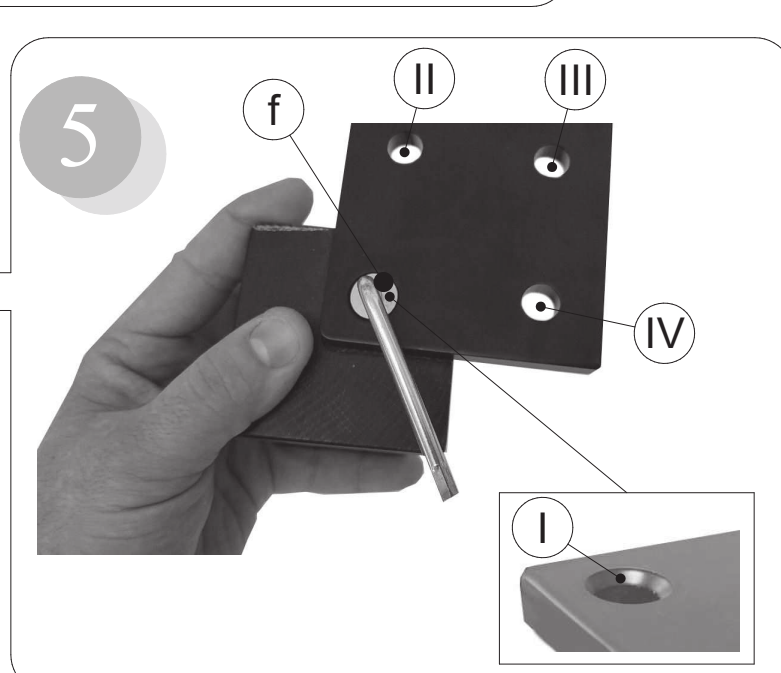
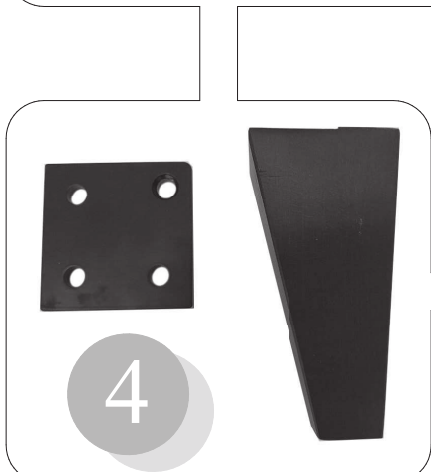
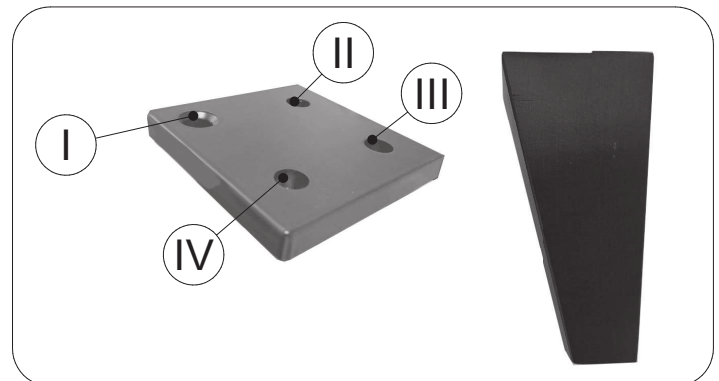

Copyright © Calligaris S.p.a. Tutti i diritti riservati - All right reserved

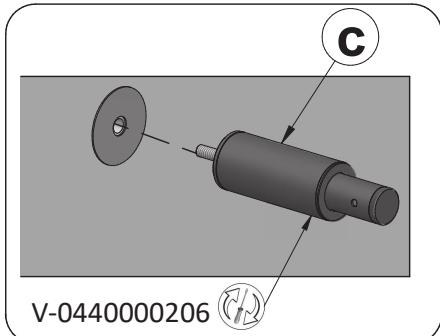
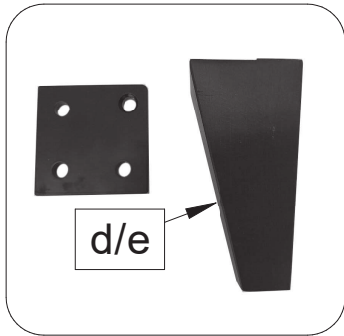

● = c
▲ = d/e

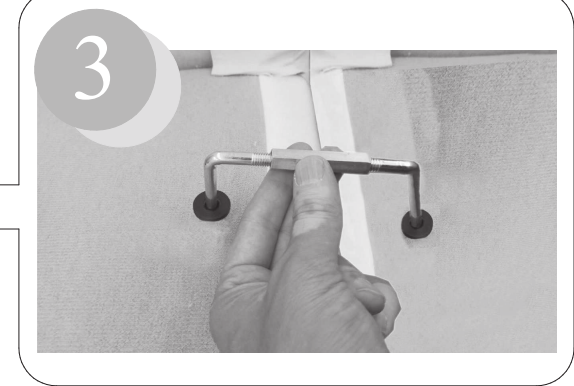
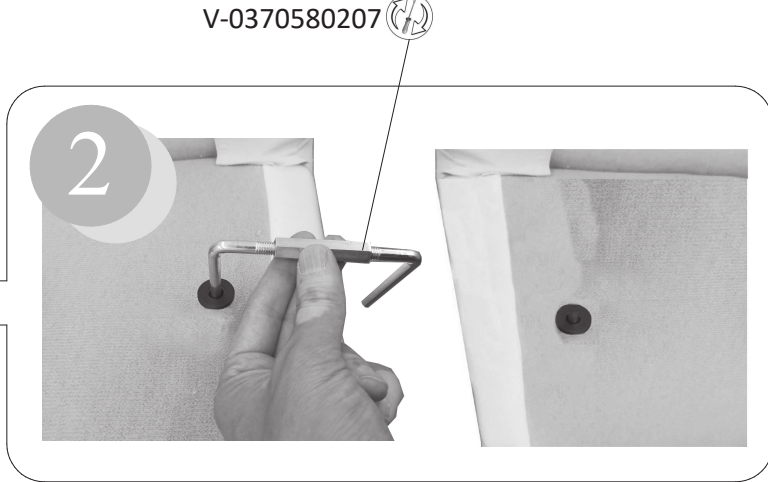
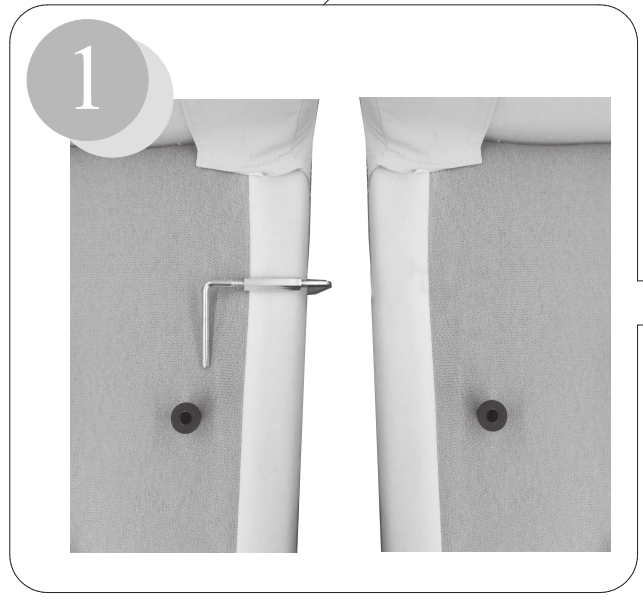
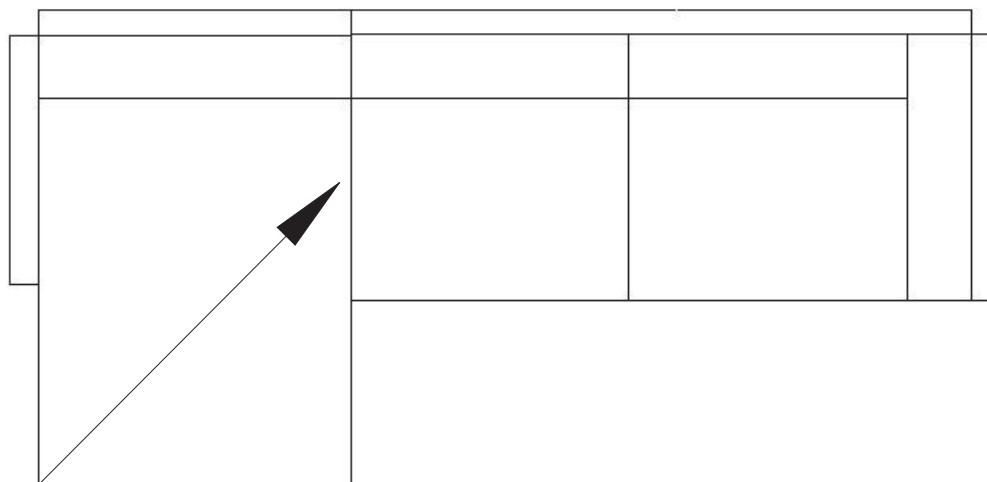
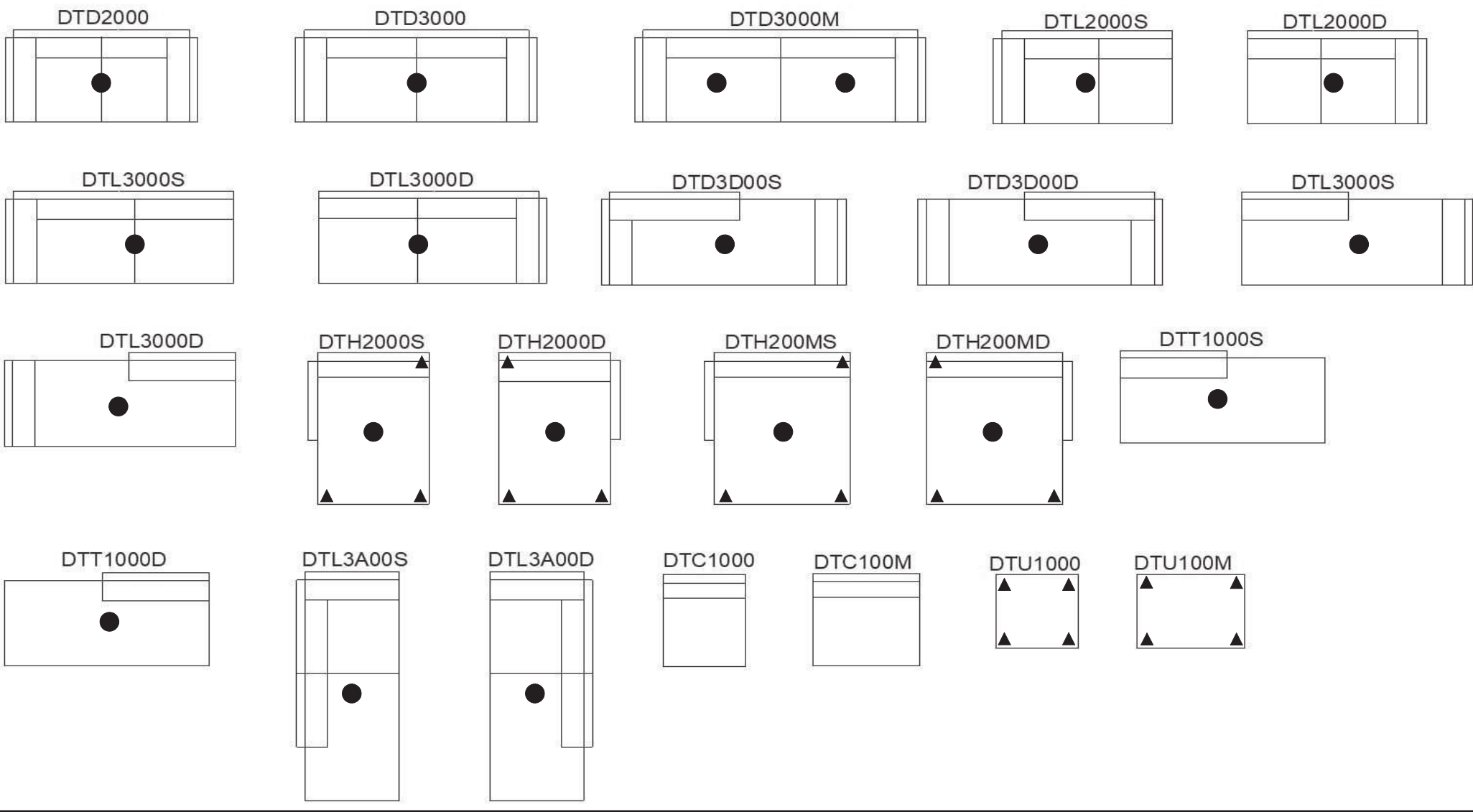

Attenzione-Attention-Vorsicht-Attention-Atención

- I Per sfoderare seguire le seguenti indicazioni.
- GB Please follow the instructions to remove the cover
- D Beim abziehen des Bezugs, bitte folgende Anweisungen beachten
- F Pour enlever la housse veuillez suivre les indications suivantes
- E Para desenfundar seguir las siguientes instrucciones

